

YAMAHA SIDEWINDER TURBO RJWC QUIET MUFFLER  
INSTALLATION MANUAL

Rev: 2.0

Before you start working on your snowmobile make sure that the engine is cold and the factory exhaust/muffler to avoid injury.

We also highly recommend you to tune your vehicle to not damage your engine due to lean fuel mixture. Contact [maptunpowersports.com](http://maptunpowersports.com) ([viktor@maptun.com](mailto:viktor@maptun.com)) for information regarding the Stage 1 (226hp) and Stage 2 (250hp) reflash .

Always check rules and regulations in your country/ state/community before installing performance increasing upgrades. RJWC products are only for racing.

### Step 1

Remove the right side plastic cover , if you want to make the work even easier we recommend you to remove the plastic hood as well.

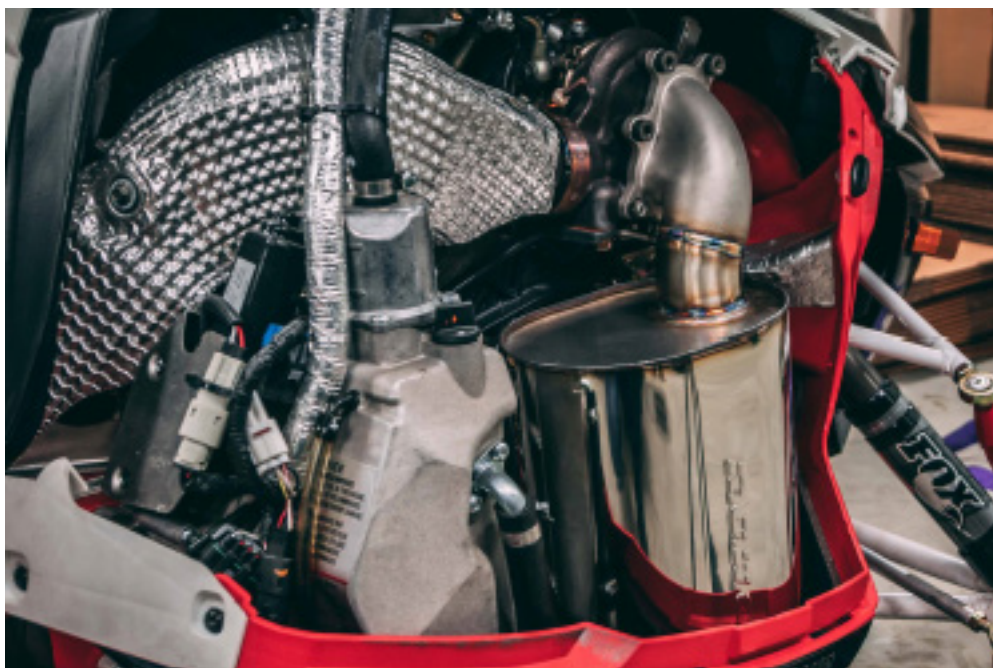

YAMAHA SIDEWINDER TURBO RJWC QUIET MUFFLER  
INSTALLATION MANUAL

Rev: 2.0

**Step 2**

Remove the aluminum heatshield that covers the factory muffler. It sits in place with 5 bolts. For the bolts that sits on the header manifold use an 8 mm socket. For the other 3 bolts use an torx tool (27). Be careful with the heatshield as we recommend that you re use it with the new RJWC muffler.

**Step 3**

Remove the factory muffler. Start by removing the spring holding the rear bracket/tab in place. Then remove all torx screws (45) holding the flange in place, see picture below. Be careful with the factory ss gasket.

**Step 4**

Time to install the new RJWC muffler. Start by installing the small billet tab that is included with the hardware parts. Just slide it in the factory rubber bushing in the frame like the picture below shows. This can not be done when the muffler is installed so its important you do this before you install the new muffler.

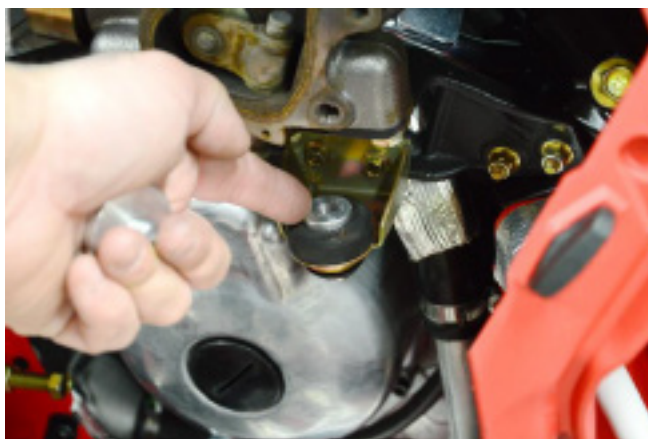

YAMAHA SIDEWINDER TURBO RJWC QUIET MUFFLER  
INSTALLATION MANUAL

Rev: 2.0

**Step 5**

It's critical that you attach the self adhesive heatshield included in the package.

You attach it to the black plastic in the center of the stator aluminum cover (see image below)

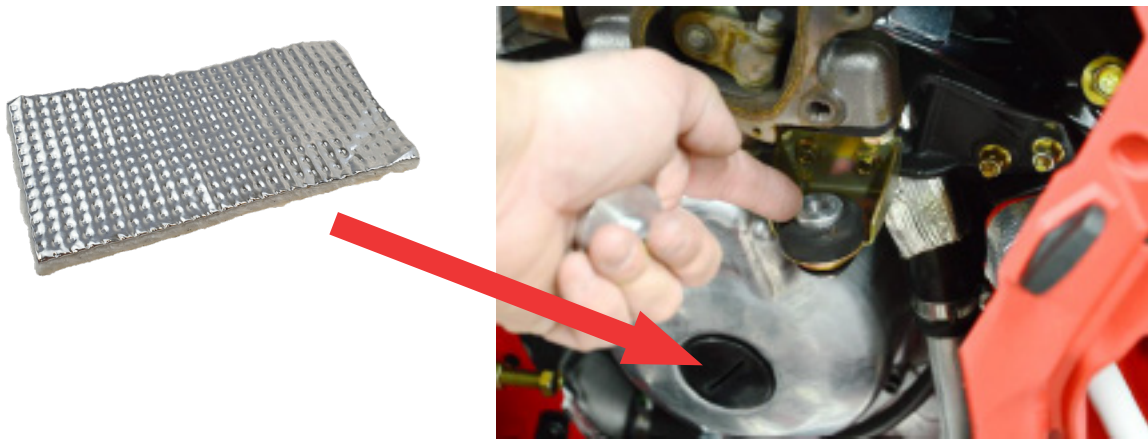
**Step 6**

Install the factory rubber bushing (see picture below) on the lower bracket on the RJWC muffler. Push the bushing through the stainless bracket and slide the 30 mm plastic washer over and make sure the rubber bushing overlaps the plastic washer. Use a small flat screwdriver to get the bushing to fit (it's tight)



YAMAHA SIDEWINDER TURBO RJWC QUIET MUFFLER  
INSTALLATION MANUAL

Rev: 2.0

**Step 7**

Install the new RJWC muffler by sliding in the lower bracket and rubber bushing into the factory location on the snowmobile. Re-use the stock turbo gasket and start with the lower left bolt the one in the picture.

**Step 8**

Install and tighten the bolt for the upper bracket and use the washer that was included with the hardware.





YAMAHA SIDEWINDER TURBO RJWC QUIET MUFFLER  
INSTALLATION MANUAL

Rev: 2.0

Step 9

Tighten all the bolts on the stainless casted flange even



Step 10

Re-install the factory heatshield and all the plastics

